

# STONE FENCE FARM

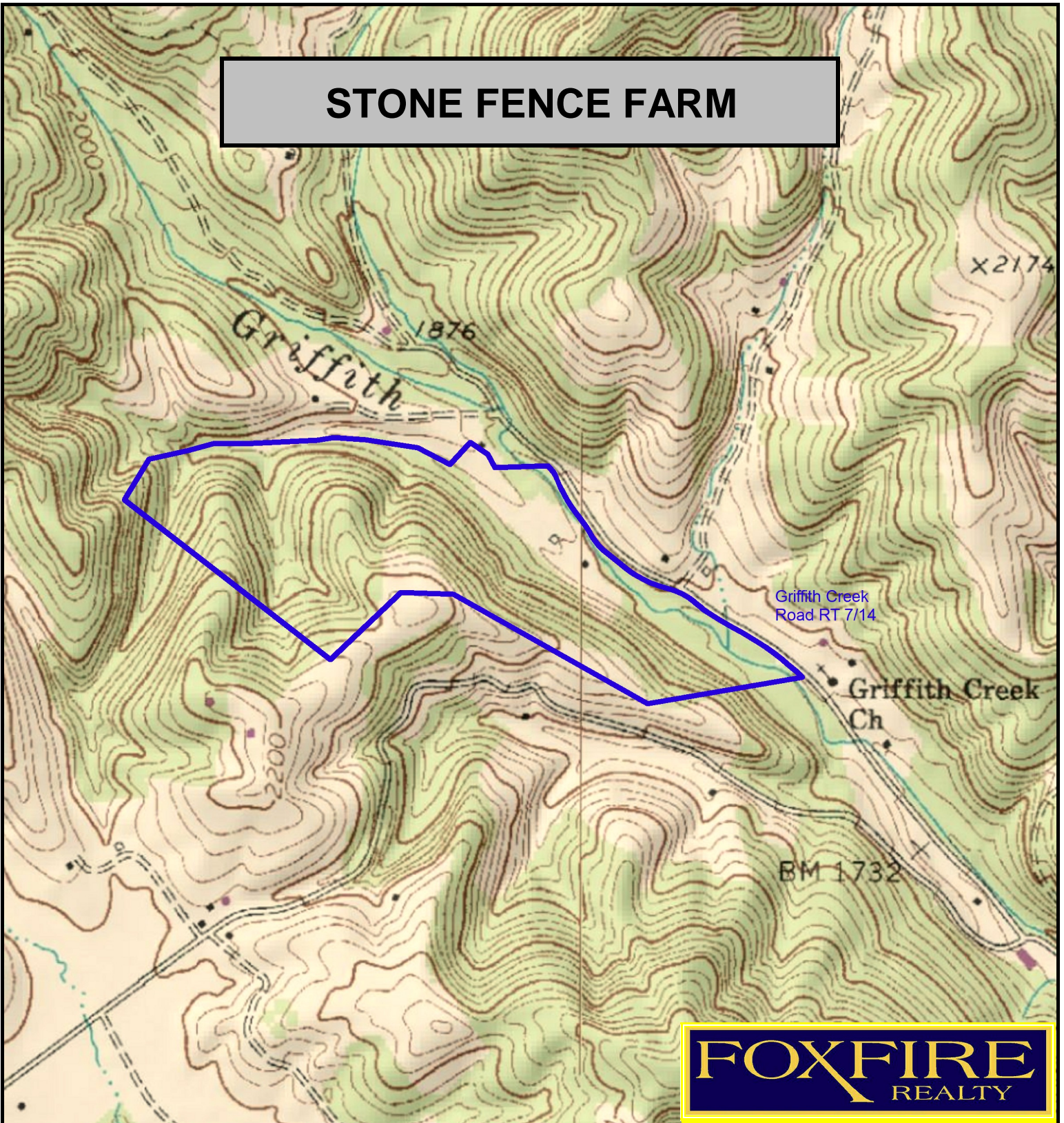

**FOXFIRE**  
REALTY

STONE FENCE FARM, Summers County, WV (topographic map)  
Elevation Range: 1769' - 2105' +/- Google Coordinates:  
LAT 37.736744 (N), LON -80.707750 (W)  
This map is for general location purposes only. Consult a licensed  
land surveyor for actual boundary location and acreage.

RICHARD GRIST, Broker - Auctioneer - Forester  
304.646.8837 Richard@Foxfirenation.com  
WWW.FOXFIRENATION.COM

FOR TOPO MAP

SCALE 1:9600

1 INCH = 800 FT.

