

JEFFREY J. BLANKENSHIP  
DB 249, PG 808

AND

WILLIAMS B. HOBBS  
D.B. 252, PG 634

5.95 Ac.

LINE 150.70' LONG  
(58.56' TOTAL)

William Hobbs House

IRON ROD IN OLD FENCE LINE BESIDE "LOUISIANA STATE OF APPALACHIAN POWER COMPANY" SUBDIVISION BY HOBBS AS HIS CORNER

Road Used As Access By William Hobbs

1200 Rod RICKY CARROLL DB 257, PG 891

VIOLET B. OULD ETAL  
DB. 243, PG. 01

PLAT showing property of the Celco Federal Credit Union located between Lurich and Glen Lyn Western Magisterial District Giles County, Virginia Scale 1" = 100' March 25, 1995

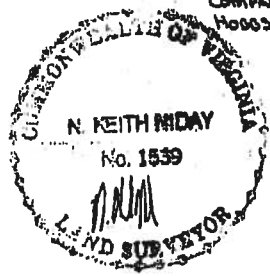

N. Keith Niday  
Land Surveyor  
Giles, Virginia

- NOTES:
- 1) Reference Deed of Trust in D.B. 225, Page 357, Second Parcel.
  - 2) This plat was prepared without the benefit of a lawyers title report and does not show right of ways or easements that may pertain to this property.