

# Bridle Trail

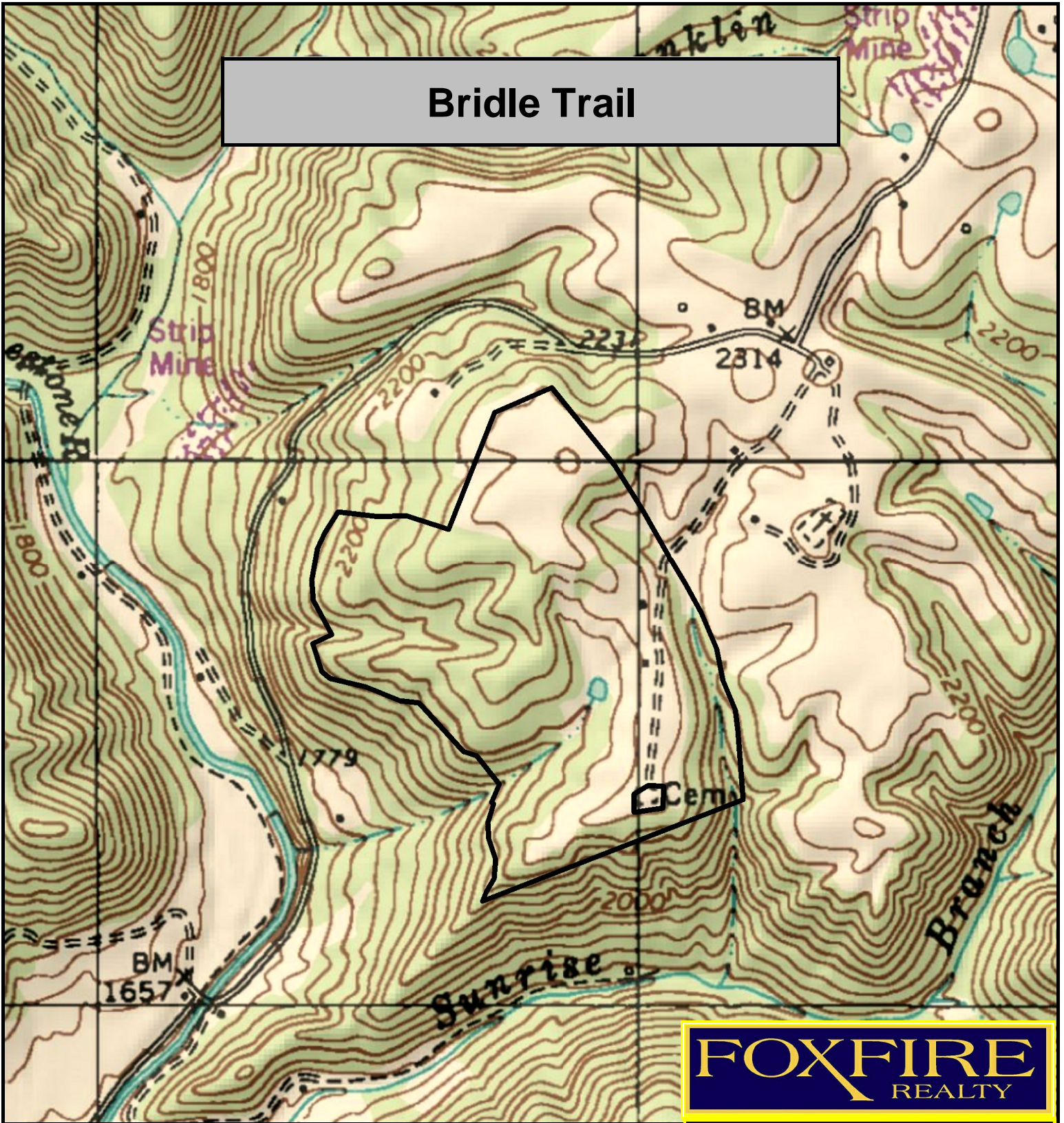

**FOXFIRE**  
REALTY

Bridle Trail, Summers County, WV  
TOPOGRAPHIC MAP  
Elevation Range: 2130' - 2365' +/-  
Google Coordinates: LAT 37.622325 (N), LON -80.976944 (W)  
This map is for general location purposes only. Consult a licensed land  
surveyor for actual boundary location and acreage.

RICHARD GRIST, Broker - Auctioneer - Forester  
304.646.8837 Richard@Foxfirenation.com  
WWW.FOXFIRENATION.COM



FOR TOPO MAP SCALE 1:9600 1 INCH = 800 FT.

