

Simms Mountain Farm

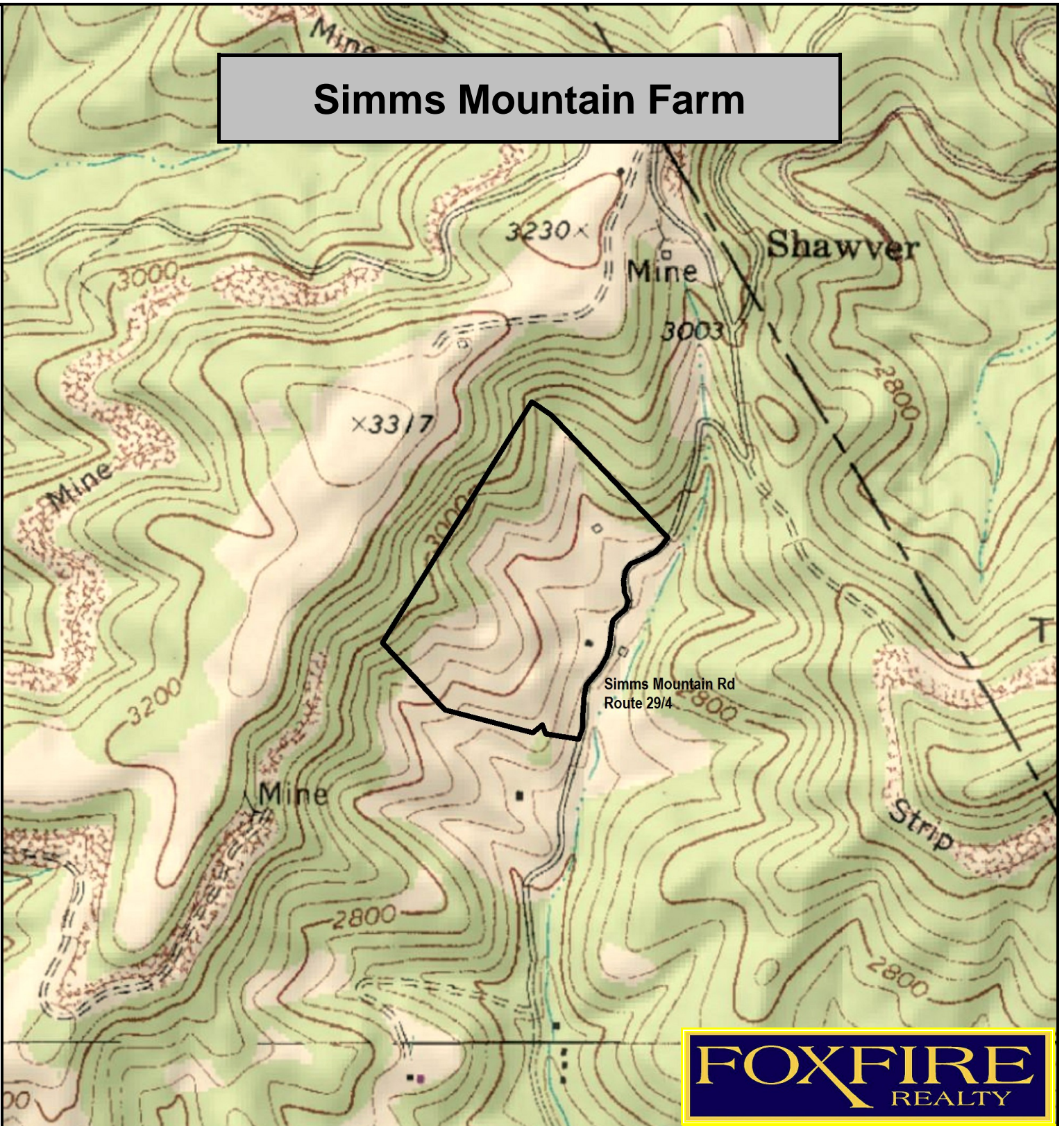

FOX FIRE
REALTY

Simms Mountain Farm, Fayette County, WV
TOPOGRAPHIC MAP
Elevation Range: 2655' - 2991' +/-
Google Coordinates: LAT 37.881642 (N), LON -80.768236 (W)
This map is for general location purposes only. Consult a licensed land surveyor for actual boundary location and acreage.
PROPERTY DEPICTION IS DERIVED FROM DEED DESCRIPTION.

RICHARD GRIST, Broker - Auctioneer - Forester
304.645.7674 Richard@Foxfirenation.com
WWW.FOXFIRENATION.COM

