

# Thomas Homeplace on Cornbread Ridge Tract B

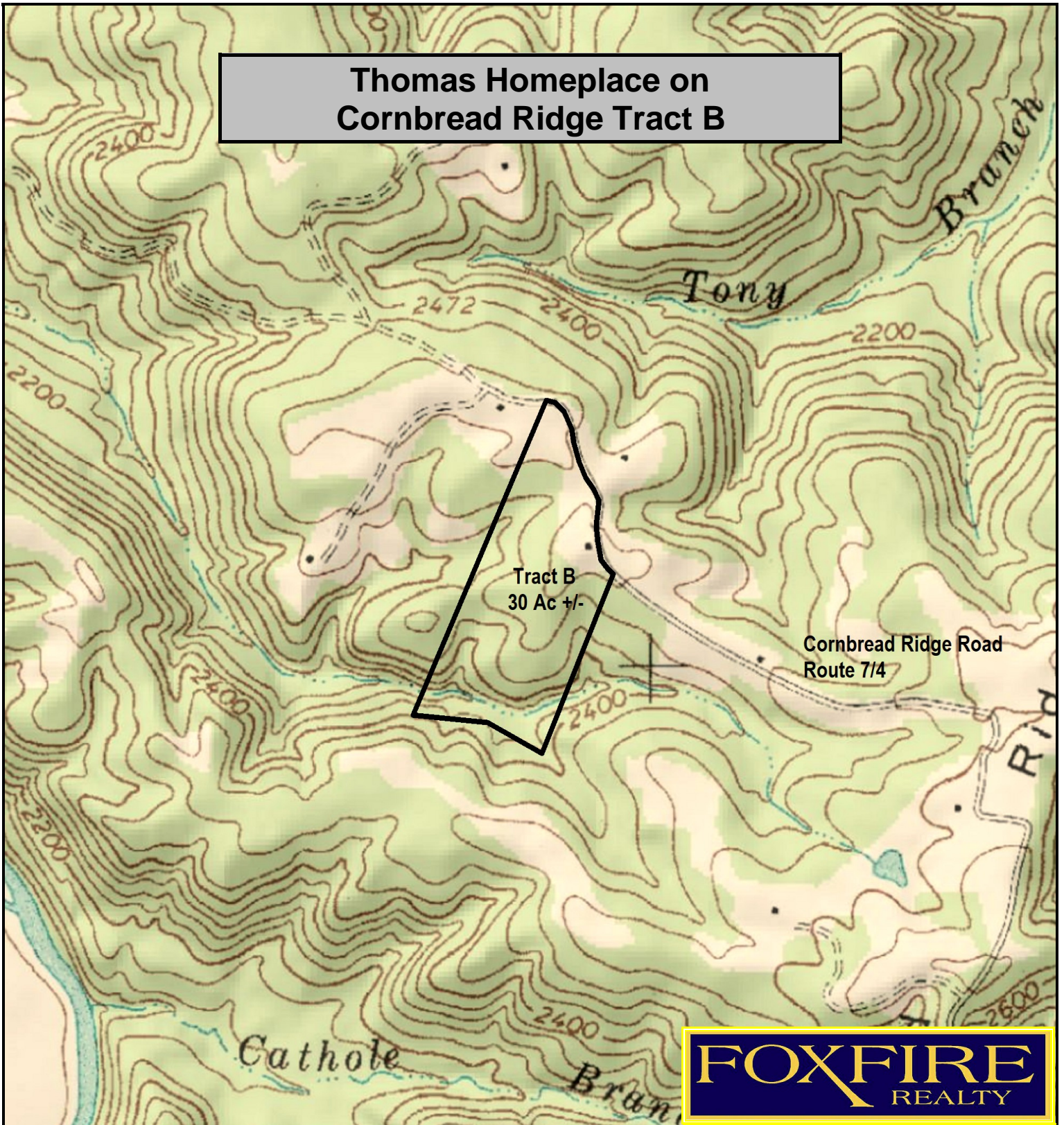

**FOX FIRE**  
REALTY

Thomas Homeplace Tract B, Mercer County, WV  
TOPOGRAPHIC MAP  
Elevation Range: 2390' - 2544' +/-  
Google Coordinates: LAT 37.460548 (N), LON -81.084163 (W)  
This map is for general location purposes only. Consult a licensed land  
surveyor for actual boundary location and acreage.

RICHARD GRIST, Broker - Auctioneer - Forester  
304.645.7674 Richard@Foxfirenation.com  
WWW.FOXFIRENATION.COM



FOR TOPO MAP SCALE 1:9600 1 INCH = 800 FT.

